

## contact details

company: \_\_\_\_\_

contact person: \_\_\_\_\_

phone: \_\_\_\_\_

e-mail: \_\_\_\_\_

date: \_\_\_\_\_

**Send configuration now!**

*Please fill in the following information to configure your Mediastele Smart!*

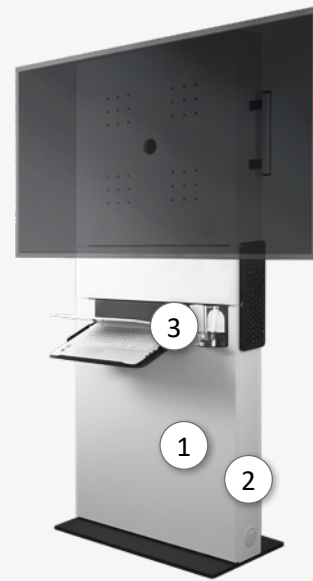

- Mediastele Smart-S** (fig.)  
 dimensions:  
 H 181 x W 72 x D 14,3 cm  
 load capacity: up to 100 kg  
 display: up to max. 86"

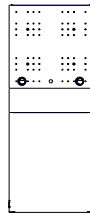

quantity: \_\_\_\_\_

- Mediastele Smart-XL**  
 dimensions:  
 H 181 x W 100 x D 14,3 cm  
 load capacity: up to 150 kg  
 display: up to max. 98"

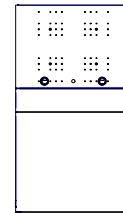

quantity: \_\_\_\_\_

### 1 Decors

- standard front panel in platinum white  
 special decor (surcharge): \_\_\_\_\_

### 2 Powder-coated

- standard powder-coated (RAL 9016 Traffic white)  
 special finish corpus acc. to RAL Classic (surcharge)  
 your desired RAL colour: \_\_\_\_\_

### 3 Optional (surcharge)

- Bracket for 2 displays (55") (Smart-S)  
 Clipboard inside



- Camera shelf, RAL 7016 Anthracite Grey



- Transport handles for mounting on side, set of 2



- Bracket for 2 displays (65") (Smart-XL)

- 19" module to hold the technology



- 3-way socket strip, cable removable

- Integrated storage compartment (in the middle front panel)

- Roller module with 6 rollers



- Cup holder, RAL 7016 Anthracite Grey

